

# SJZ Metalsin Tech Co Ltd

## Light-duty Rigid Coupling

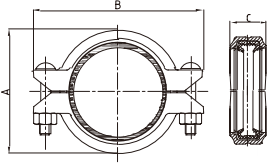

Nominal Size mm/in	Pipe O.D mm/in	Working Pressure PSI/MPa	Max. End Load kN/Lbs	Pipe End Separation mm/in	Dimensions			Bolt Size No.-Size mm	Certificate
					A mm/in	B mm/in	C mm/in		
80 3	88.9 3.500	350 2.41	15.0/3360	0-3.2 0-0.13	114 4.50	160 6.30	45 1.78	2-3/8X55 2-M10X57	UL FM VdS LPCB
100 4	108.0 4.250	300 2.07	18.9/4260	0-3.2 0-0.13	135 5.30	185 7.28	50 1.97	2-1/2X70 2-M12X70	UL FM LPCB
100 4	114.3 4.500	350 2.41	24.7/5560	0-3.2 0-0.13	140 5.51	192 7.56	46.5 1.83	2-1/2X70 2-M12X70	UL FM VdS LPCB
125 5	139.7 5.500	350 2.41	36.9/8300	0-3.2 0-0.13	168 6.62	225 8.86	50 1.97	2-1/2X75 2-M12X76	UL FM LPCB
125 5	141.3 5.563	350 2.41	37.8/8490	0-3.2 0-0.13	170 6.69	225 8.86	50 1.97	2-1/2X75 2-M12X76	UL FM LPCB
150 6	159.0 6.250	300 2.07	41.0/9240	0-3.2 0-0.13	190 7.48	252 9.92	50 1.97	2-5/8X80 2-M16X85	UL FM LPCB
150 6	165.1 6.500	350 2.41	51.6/11600	0-3.2 0-0.13	195 7.68	250 9.84	50 1.97	2-1/2X75 2-M12X76	UL FM LPCB
150 6	168.3 6.625	350 2.41	53.6/12000	0-3.2 0-0.13	200 7.87	255 10.04	50 1.97	2-1/2X75 2-M12X76	UL FM LPCB
200A 8	216.3 8.516	300 2.07	76.0/17100	0-3.2 0-0.13	255 10.04	320 12.60	58 2.28	2-5/8X85 2-M16X85	UL FM
200 8	219.1 8.625	350 2.41	90.8/20430	0-3.2 0-0.13	255 10.05	324 12.76	58 2.28	2-5/8X85 2-M16X85	UL FM LPCB
250 10	273.0 10.750	300 2.07	121.0/27210	0-3.2 0-0.13	318 12.52	410 16.14	63 2.48	2-3/4X120 2-M20X115	UL FM

## Angle Pad Coupling

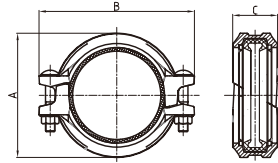

Nominal Size mm/in	Pipe O.D mm/in	Working Pressure PSI/MPa	Max. End Load kN/Lbs	Pipe End Separation mm/in	Dimensions			Bolt Size No.-Size mm	Certificate
					A mm/in	B mm/in	C mm/in		
32 1 1/4	42.4 1.669	500 3.45	4.8/1080	0-1.6 0-0.06	64 2.52	99 3.90	46.5 1.83	2-M10X55	UL FM
40 1 1/2	48.3 1.900	500 3.45	6.3/1420	0-3.2 0-0.13	70 2.76	105 4.13	46.5 1.83	2-M10X55	UL FM
50 2	60.3 2.375	500 3.45	9.8/2210	0-3.2 0-0.13	85 3.35	121 4.76	46.5 1.83	2-M10X55	UL FM
65 2 1/2	73.0 2.875	300 2.07	8.7/1950	0-3.2 0-0.13	99 3.90	134 5.28	47.5 1.87	2-M10X63	UL FM
65 2 1/2	76.1 3.000	500 3.45	15.7/3520	0-3.2 0-0.13	102 4.02	137 5.39	47.5 1.87	2-M10X63	UL FM
80 3	88.9 3.500	500 3.45	21.4/4810	0-3.2 0-0.13	115 4.53	150 5.91	47.5 1.87	2-M10X60	UL FM
100 4	114.3 4.500	500 3.45	35.4/7960	0-3.2 0-0.13	142 5.59	180 7.09	50 1.97	2-M10X65	UL FM
125 5	139.7 5.500	300 2.07	31.7/7130	0-3.2 0-0.13	171 6.73	214 8.43	52.5 2.07	2-M12X75	UL FM
150 6	165.1 6.500	300 2.07	44.3/9960	0-3.2 0-0.13	198 7.80	242 9.53	52.5 2.07	2-M12X75	UL FM
150 6	168.3 6.625	300 2.07	46.0/10340	0-3.2 0-0.13	201 7.91	245 9.65	52.5 2.07	2-M12X75	UL FM
200 8	219.1 8.625	300 2.07	77.8/17500	0-3.2 0-0.13	258 10.16	331 13.03	63.5 2.50	2-M20X110	UL FM
250 10	273.0 10.750	300 2.07	121.0/27210	0-3.2 0-0.13	321 12.64	406 15.98	64.5 2.54	2-M22X140	UL